

Apartment for sale in Bordighera

€ 1.290.000

Ref. 3Q97

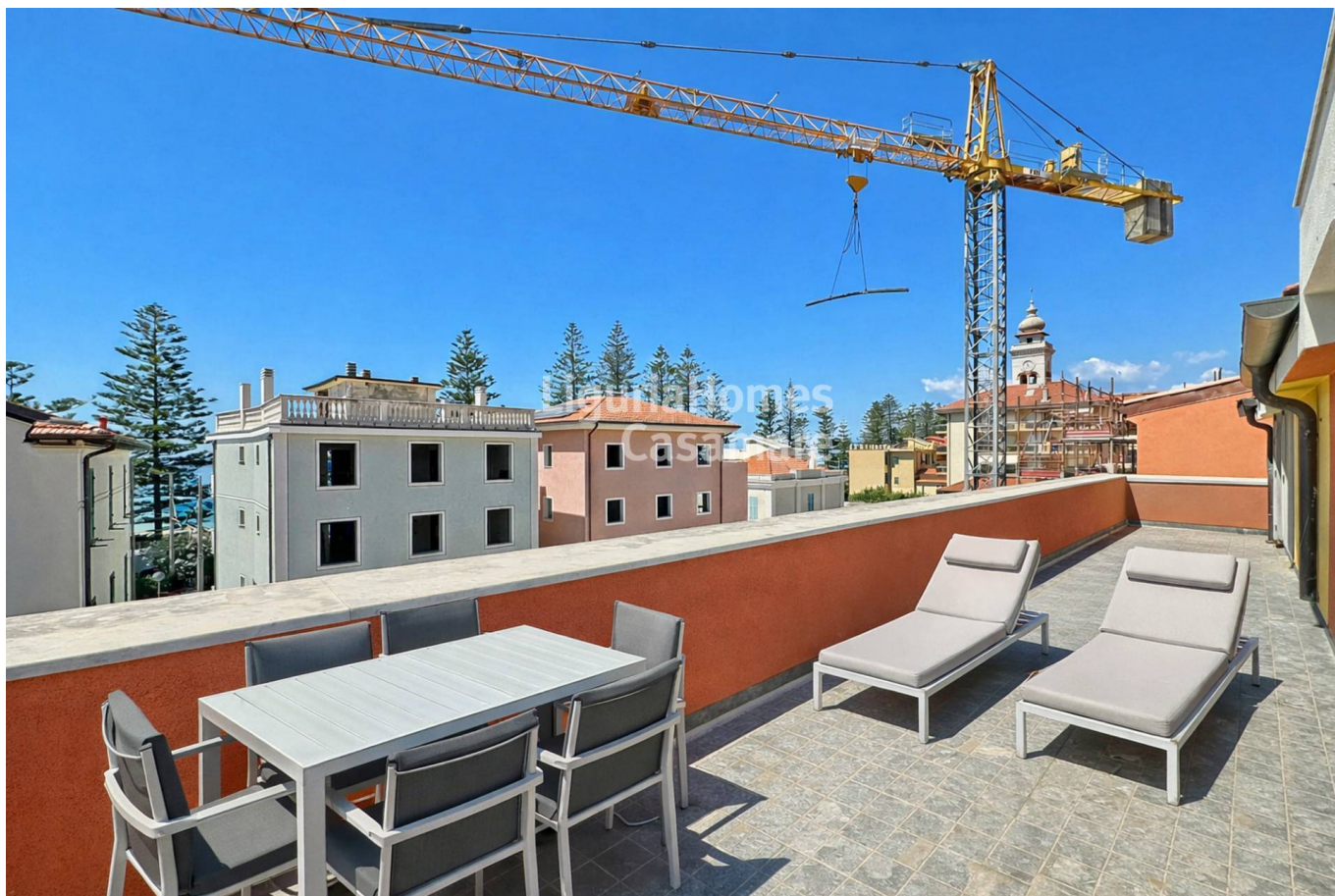

186 sq.m. | Bathrooms: 4 | Bedrooms: 4 | Rooms: 8

Le MUSE, Bordighera, new luxurious central penthouse for sale in second row on the sea front.

Le MUSE is a new residential complex in Bordighera, consisting of 4 buildings, two facing the sea and two in the second row, interspersed with a fabulous pedestrian square. It has a total of 23 exclusive flats and 7 commercial premises for Sale in the heart of the city of palm trees, Bordighera. The flats for Sale in the MUSE of Bordighera are in a privileged position, as they are located in a classy residential area that is connected to the promenade, the beach and the sea by a convenient pedestrian subway.

This magnificent Penthouse Apartment for Sale at the MUSE in Bordighera is part of building 2, in the second row on the sea, and is composed of a Penthouse Apartment all on one floor which occupies the entire third floor of the building and consists of a large and bright living area with open kitchen overlooking the spacious terrace facing South with glimpses of the sea, 4 bedrooms and 4 bathrooms as well as a second terrace facing North.

The apartments for sale at the MUSE in Bordighera offer a traditional Ligurian style and blend in perfectly with the surrounding historic buildings. They are distinguished by their quality of construction, designed with care and attention to detail, using technologies that guarantee safety and energy savings, such as the hot and cold air conditioning system, acoustic insulation between the units, external insulation, PVC double glazing, photovoltaic panels and ad hoc lighting, all

made with quality materials that guarantee not only beauty but also high thermal and acoustic comfort.

This penthouse apartment for sale at the MUSE in Bordighera may be combined with up to 2 garages of your choice in the basement, to be counted separately from the price indicated, with the possibility of recharging for electric vehicles. At this stage it is still possible to choose the cladding.

Be inspired by the MUSE in Bordighera.

Certification

Energy Class: A4

Features

Floor: Penthouse

Heating: Independent

Lift: Yes

Terrace: Present, 55 sq.m.

Garage: Double

Closet

Cellar

Air-Conditioning

Sea View

Distance from the sea : 10 mt

Nearby

Gyms

Tennis Courts

Bike Lanes

Playgrounds

Public Transport

Cafe

Post Office / Bank

